

STAIN ERASER

USER GUIDE
2005 SERIES

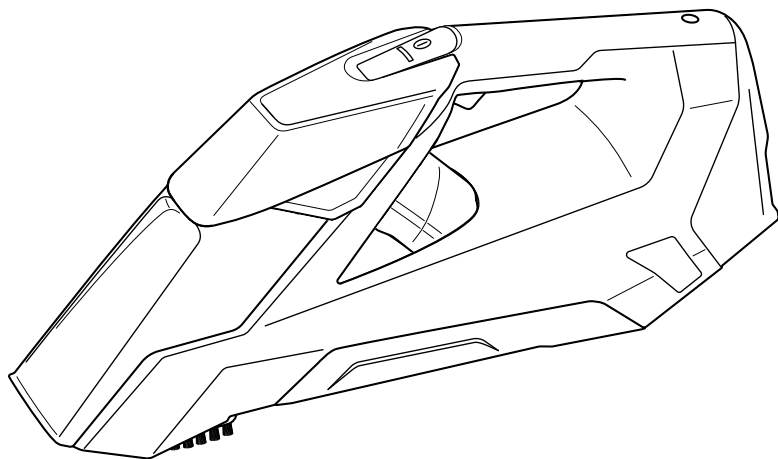

IMPORTANT SAFETY INSTRUCTIONS

**READ ALL INSTRUCTIONS
BEFORE USING YOUR CLEANER.**

When using an electrical appliance, basic precautions should be observed, including the following.

**WARNING**

TO REDUCE THE RISK OF FIRE, ELECTRIC SHOCK, OR INJURY:

- » This appliance can be used by children aged from 8 years and above and persons with reduced physical, sensory or mental capabilities or lack of experience and knowledge if they have been given supervision or instruction concerning use of the appliance in a safe way and understand the hazards involved.
- » Children shall not play with the appliance. Cleaning and user maintenance shall not be made by children without supervision.
- » If the charger supply cable is damaged, it must be replaced by the manufacturer, its service agent or similarly qualified persons in order to avoid a hazard.
- » The appliance is not to be used if it has been dropped, if there are visible signs of damage or if it is leaking.
- » Liquid must not be directed towards equipment containing electrical components.
- » Remove from charger and turn off all controls before cleaning, maintaining or servicing the appliance.
- » For the purpose of recharging the battery, only use the detachable power supply unit provided with this appliance.
- » The battery must be removed from the appliance before it is scrapped.
- » The appliance must be disconnected from the supply mains when removing the battery.
- » The battery is to be disposed of safely.
- » Use only the type and amount of liquids specified under the



- » Operations section of this guide.
- » Unplug from electrical socket when not charging.
- » Always connect to a proper electrical socket.
- » Do not allow to be used as a toy.
- » Use only as described in the user guide.
- » Use only manufacturer's recommended attachments.
- » Do not use with damaged cable or plug for charger.
- » Do not immerse in water or liquid.
- » If appliance is not working as it should, has been dropped, damaged, left outdoors, or dropped into water; do not attempt to operate it and have it repaired at an authorized service center.
- » Do not pull or carry charger by cable.
- » Keep charger away from heated surfaces.
- » Do not unplug charger by pulling on cable.
- » To unplug, grasp the plug, not the cable.
- » Do not handle charger plug or appliance with wet hands.
- » Do not put any object into openings.
- » Do not use with any opening blocked; keep free of dust, lint, hair, and anything that may reduce air flow.
- » Use extra care when cleaning on stairs.
- » Turn off all controls before charging.
- » Do not use to pick up flammable or combustible liquids, such as petrol, or use in areas where they may be present.
- » Do not pick up toxic material (chlorine bleach, ammonia, drain cleaner, etc.).
- » Do not pick up anything that is burning or smoking, such as cigarettes, matches, or hot ashes.
- » Do not use appliance in an enclosed space filled with vapors given off by oil base paint, some mothproofing substances, flammable dust, or other explosive or toxic vapors.
- » Do not pick up hard or sharp objects such as glass, nails, screws, coins, etc.
- » Do not use without collection tank in place.
- » Keep the temperature range of between 0-40°C (32-104°F) when charging battery, storing unit or during use.
- » Ensure to use the appropriate charger by series. For all UK models, reference charger series SSA-100060UK.

SAVE THESE INSTRUCTIONS

**FOR CHARGING ON A 220-240 VOLT A.C.
50/60 Hz POWER SUPPLY ONLY.**
This model is for household use only.

**WARNING**

**FOR SAFE OPERATION AND BATTERY REMOVAL
AND TO REDUCE THE RISK OF INJURY, USER
MUST READ AND UNDERSTAND USER GUIDE.
STORE INDOORS.**

	WARNING	RISK OF FIRE, ELECTRIC SHOCK, OR INJURY.
	GUIDE	READ USER GUIDE FOR COMPLETE SAFETY AND USER INSTRUCTIONS.
	WEEE	DO NOT THROW THE APPLIANCE AWAY WITH THE NORMAL HOUSEHOLD WASTE AT THE END OF ITS LIFE, BUT HAND IT IN AT AN OFFICIAL COLLECTION POINT FOR RECYCLING. BY DOING THIS YOU WILL HELP TO PRESERVE THE ENVIRONMENT.

Thanks for buying a BISSELL portable deep cleaner!

We love to clean and we're excited to share one of our innovative products with you. We want to make sure your portable deep cleaner works as well in two years as it does today, so this guide has tips on using (pages 5-9), maintaining (pages 10-13), and if there is a problem, troubleshooting (page 14).

In just a few simple assembly steps, you'll be ready to spot clean. Flip to page 5 and let's get started!



What's In The Box?

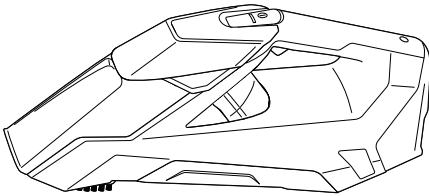

Stain Eraser Pet

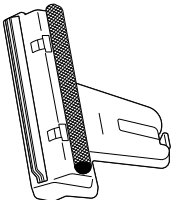

Window Cleaning Tool
(select models)

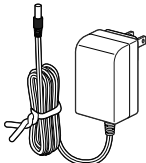

Charger
Plug/Cord



Round Bristle Brush
(select models)



Straight Bristle Brush
(select models)

NOTE: Standard accessories may vary by model. To identify what should be included with your purchase, please refer to the 'carton contents' list located on the side of the carton.

Safety Instructions.....	2	Maintenance & Care	10-13
Product View.....	4	Troubleshooting	14
Cleaning Formula.....	4	Guarantee.....	15
Operations	5-9	Consumer Care.....	16

Product View

1. Formula and Clean Water Tank
2. Removable Nozzle
3. Scrubbing Brush
4. Tank Release Latch
5. Dirty Water Tank
6. Battery Charging Port
7. Spray Trigger
8. Power Switch
9. Battery Status Indicator Lights
10. Charger Plug/Cord
11. Window Cleaning Tool (select models)

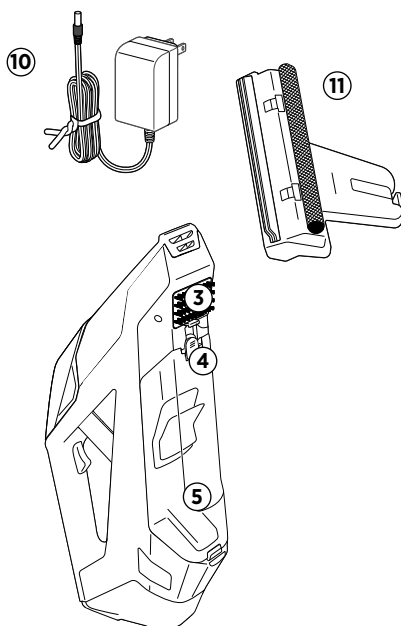

Cleaning Formula



BISSELL
OXY Boost



BISSELL 2X Pet
Stain & Odor



BISSELL
Spot & Stain

Keep plenty of genuine BISSELL Spot & Stain Cleaner formula for portable spot cleaning machines on hand so you can clean whenever it fits your schedule. Always use genuine BISSELL cleaning formulas.

NOTICE: Use of cleaning formulas which contain lemon or pine oil may damage this appliance and void the guarantee. Chemical spot cleaners or solvent-based soil removers also should not be used. These products may react with the plastic materials used in your cleaner, causing cracking or pitting.

Charging the Battery

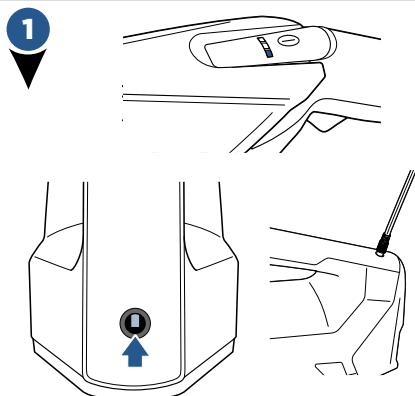

Before charging, make sure unit is off by ensuring the battery status indicator lights are not illuminated. Insert the charging adapter plug into the charging port on the handle near the base of the unit.

NOTE: There is a door covering the charging port that will automatically slide out of the way when the charging adapter is inserted.

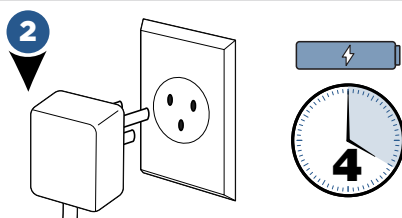

Plug the adapter into a suitable wall outlet. The battery status indicator lights will illuminate when charging.

For maximum run time, charge the unit 4 hours prior to use. Refer to the chart below for understanding the charging status.

NOTE: On first use, make sure your unit is fully charged before using it. To check the battery status, turn the machine ON by pressing the power button on the handle. Battery is fully charged when all three of the blue status lights are illuminated. See chart below.

IMPORTANT: Before storing unit, ensure dirty water tank is empty. Unit should not be left on its side with water in the dirty water tank.

Charging Light Display Status



BATTERY STATUS	LIGHT STATUS
100%	
99% to 66%	
65% to 33%	
32% to 1%	
0%	

NOTE: Keep the temperature range of between 0-40°C (32-104°F) when charging battery, storing unit or during use.

NOTE: Use only with charger SIL, Model SSA-100060UK.

Filling the Solution Tank

1

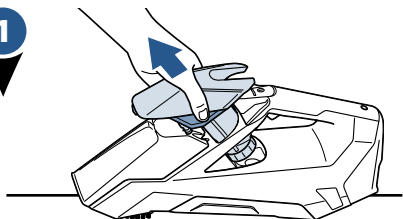

Pull the tank away at an angle to remove it from the unit.

2

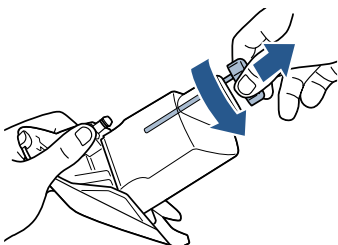

Twist and remove the tank cap.

3

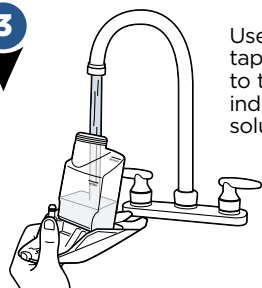

Use hand-warm tap water to fill to the water line indicated on the solution tank.

4

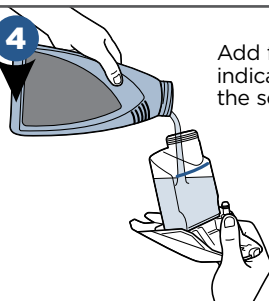

Add formula to the indicated fill line on the solution tank.

5

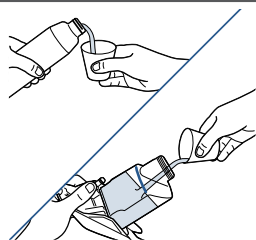

If desired, add 1/2 ounce of BISSELL BOOST Formula to 2X Pet Stain & Odor formula.

6

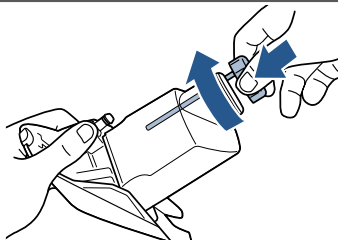

Twist to replace the cap on the tank.

7



Return the tank to the unit making sure it is fully seated.

8

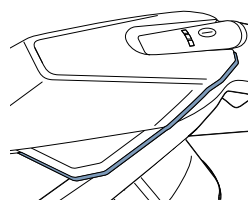

To ensure the tank is fully seated, make sure there are not gaps in the seams between the tank and unit.

Pre-Treating

IMPORTANT: Check the manufacturer's tag before cleaning upholstery. "W" or "WS" on the tag means you can use your Stain Eraser Pet. If tag is coded with an "S" (with diagonal strike-through), or says "Dry Clean Only," do not proceed. If manufacturer's tag is missing or not coded, check with your furniture dealer.

1

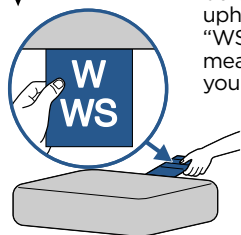

Check the manufacturer's tag before cleaning upholstery. "W" or "WS" on the tag means you can use your Pet Stain Eraser.

2

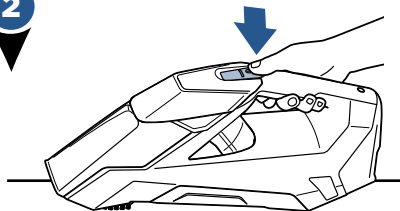

Push power button to turn the unit ON.

3

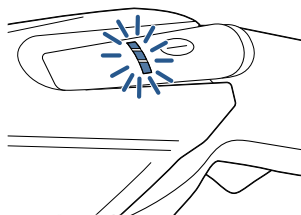

Battery status lights will illuminate to show how much battery remains.

4

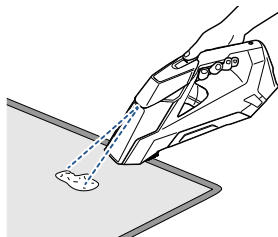

To pretreat stained or soiled areas, hold the unit above soiled surface and press spray trigger until the entire area is wet.

5



Let cleaning solution set for 5 minutes before cleaning.

Spot Cleaning Carpet & Upholstery

WARNING

Keep spray away from face. Failure to do so may result in personal injury.

NOTE: If unit stops spraying, push power button to turn unit off and check cleaning solution level. Refill if needed. Never run dry.

NOTE: When cleaning upholstery, be sure to use the unit vertically upward.

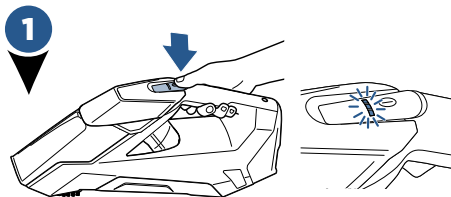

Push power button to turn the unit ON. Battery status lights will illuminate to show how much battery remains.

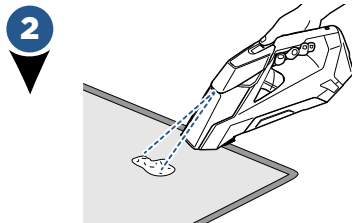

Hold the unit above soiled surface and press the trigger to spray cleaning solution.

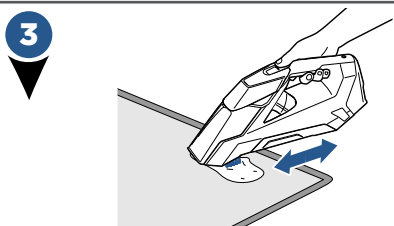

For stubborn spots, use brush to gently scrub soiled area while continuing to spray cleaning solution.

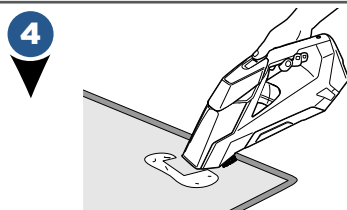

Press front of unit firmly against surface and pull toward you to remove cleaning solution. Be sure to release the trigger for optimal suction.

5 Repeat steps 2 and 4 until no more dirt or cleaning solution can be removed. Do not overwet.

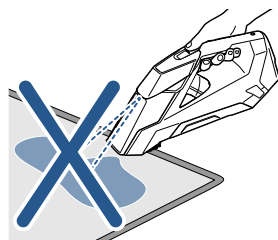
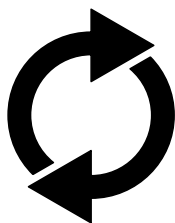

Window Cleaning (select models)

1

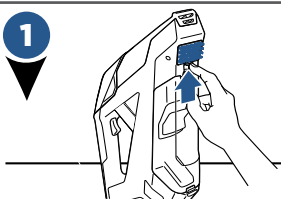

Remove scrubbing brush by pushing tab up and pulling gently.

2

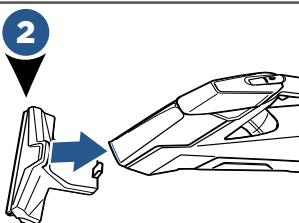

Attach window cleaning tool by first securing on the clear nozzle.

3

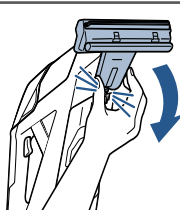

Then rotate window cleaning tool until it clicks into place.

METHOD 1

4

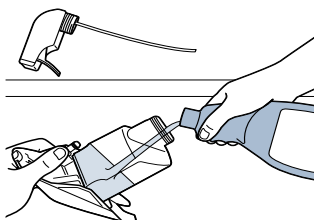

Rinse tank to remove any previous contents. Fill with window cleaner (not included).

5

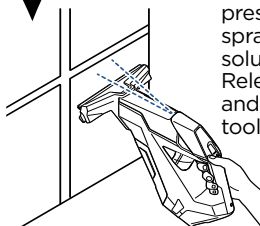

Hold machine in vertical position in front of window and press spray trigger to spray window cleaning solution onto window. Release spray trigger and use sponge on the tool to gently scrub.

Go to step 6.

METHOD 2

4

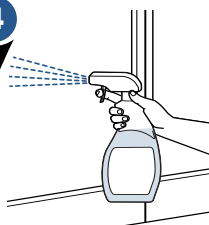

Spray window cleaning solution directly on the window.

5

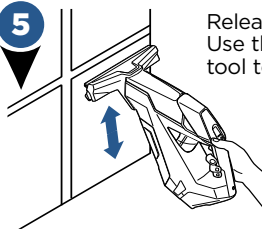

Release spray trigger. Use the sponge on the tool to gently scrub.

6

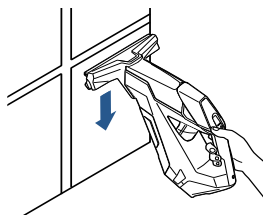

Spray trigger still released, tilt cleaner down to engage the squeegee. Clean with complete vertical strokes and work across entire window.

7

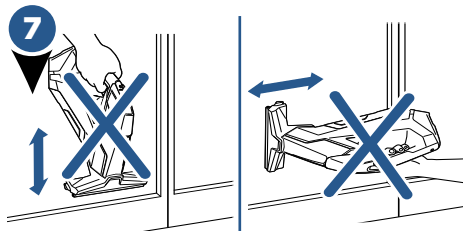

When cleaning, ensure squeegee is against window for optimal suction and hold machine in upright position.

NOTE: This machine is safe to use with any off-the-shelf ammonia-based window cleaning solutions. Do not attempt to use any other types of cleaning fluids, such as lemon-based, pine-based, or solvent based cleaning fluids, as it may damage your machine and void your guarantee.

Empty Dirty Water Tank

WARNING

To reduce the risk of fire, electric shock or injury, turn power OFF and disconnect from charger before performing maintenance or troubleshooting.

1

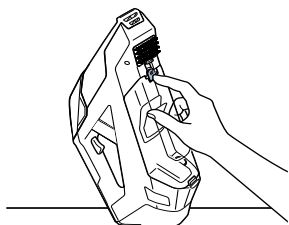

Ensure the unit is OFF and set upright on a flat surface. Simply push up on the release button located on the top of the tank to remove.

2

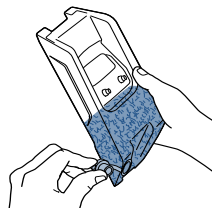

Carefully remove the dirty water tank from the unit and carry to a sink. To prevent spills, hold tank vertically after removing. To empty, pull tab at the end of the tank and empty to remove the dirty water.

3

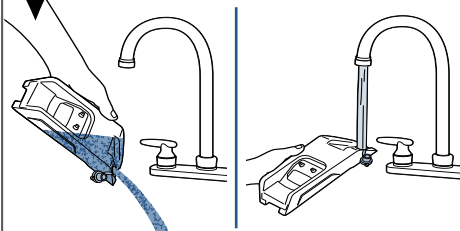

Rinse out the dirty tank with clean water after emptying.

4

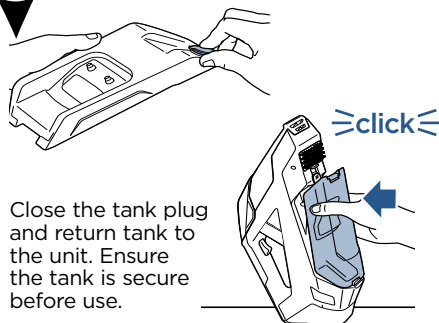

Close the tank plug and return tank to the unit. Ensure the tank is secure before use.

NOTICE: To reduce the risk of a leaking condition, do not store where freezing may occur. Damage to internal components may result.

Clean the Nozzle

⚠ WARNING

To reduce the risk of fire, electric shock or injury, turn power OFF and disconnect from charger before performing maintenance or troubleshooting.

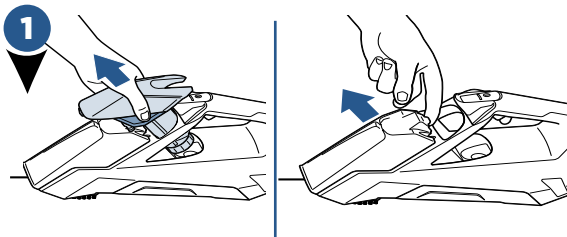

The front nozzle of the unit removes for easy cleaning of dirt and debris. Remove the clean water tank and locate the latch at the top of the nozzle. Pull tab and rotate back to separate from unit.

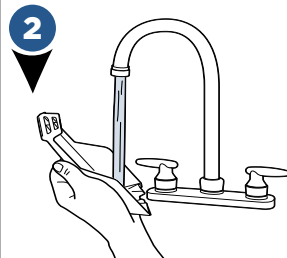

Rinse nozzle with clean water and check spray nozzle for dirt or debris.



If necessary, wipe with a clean cloth or soft bristle brush.

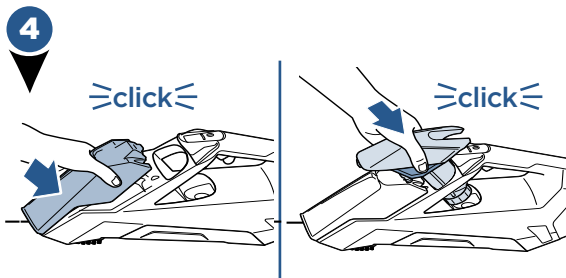

Replace the front nozzle by hooking lower edge onto unit and snapping into place. Then place the clean tank back on the unit.

Clean the Brush

WARNING

To reduce the risk of fire, electric shock or injury, turn power OFF and disconnect from charger before performing maintenance or troubleshooting.

1

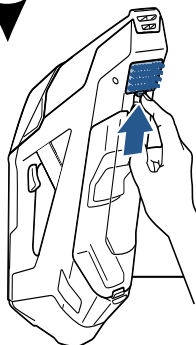

Ensure the unit is OFF and set upright on a countertop or flat surface. Remove the scrubbing brush by lifting the tab up and pulling gently to release.

2

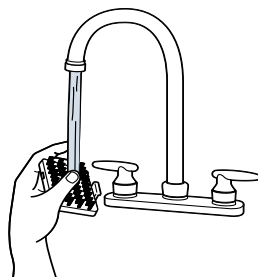

Rinse brush with clean water and check brush for debris. Once cleaned, insert brush by aligning the top of the brush into the unit and snap into place. Ensure it is secure before using.

Clean the Window Tool (select models)

WARNING

To reduce the risk of fire, electric shock or injury, turn power OFF and disconnect from charger before performing maintenance or troubleshooting.

1

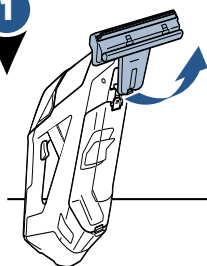

Remove window cleaning tool by pushing the tab upward on the back of the unit and pulling gently.

2

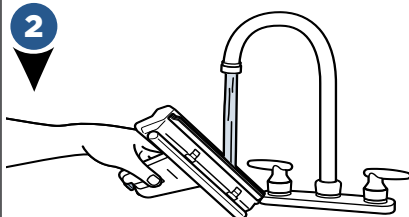

Rinse tool under water and let air dry.

Disposal of Batteries

WARNING

This product contains Lithium Ion rechargeable batteries. Proper removal and disposal of batteries is required.

NOTICE: Disconnecting the battery will destroy the appliance and invalidate the guarantee.

Before proceeding, ensure that:

- the unit is disconnected from the charger
- the clean water tank, collection tank, nozzle and brush have been removed from unit (see removal instructions on pages 10-12)
- you have a flat head and Phillips screwdriver, required for disassembly

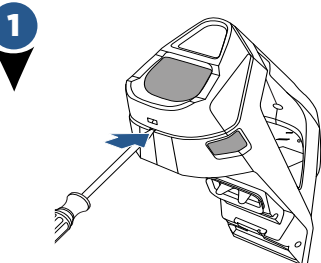

Remove the cover on the base of the unit by using a flat head screw driver.

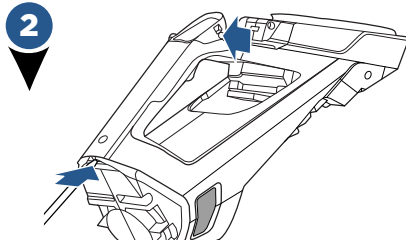

Remove the screw near the LED window using a Phillips screwdriver. Then, remove entire top handle portion from unit by using a flat head screwdriver.

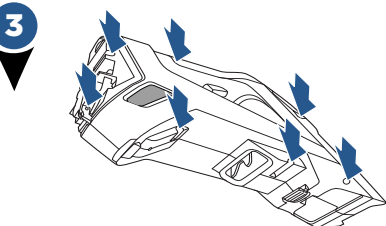

Using a Phillips screwdriver, remove seven screws in the locations referenced in the image.

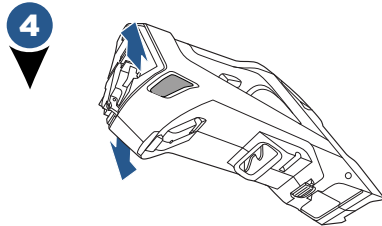

Remove product rating label. Pull open the housing on the base of the unit in opposite directions. Disconnect and remove the entire battery assembly.

NOTE: Keep Battery Pack together – DO NOT separate individual batteries. For specific disposal instructions of batteries, please follow local regulations.

Troubleshooting

WARNING

To reduce the risk of electric shock, turn power switch off and disconnect from charger before performing maintenance or troubleshooting checks.

Problem	Possible causes	Remedies
Reduced suction or no suction	Dirty water tank is full	Empty dirty water tank
	Dirty water tank drain plug is loose	Check plug for snug fit
	Batteries weak/undercharged	Recharge according to instructions
	Dirty water tank not properly installed	Snap tank into place
Reduced or no suction on the window tool (select models)	Nozzle improperly installed	Remove and reinstall nozzle
	Squeegee is tilted away from the window	Ensure the squeegee is against the window for optimal suction
	Improperly attached window tool	Remove and reinstall window tool
Reduced spray or no spray	Solution/clean tank is empty	Refill solution/clean tank
	Pump not primed	While the unit is turned on, press spray trigger and gently rock Pet Stain Eraser back and forth
	Batteries weak/undercharged	Recharge according to instructions
	Spray tip clogged	Rinse tip with clean water
	Clean tank not fully inserted	Ensure clean tank is securely seated by removing and then replacing
Unit is not powered or underpowered	Charger plug/cord not connected	Make sure charger plug is completely plugged into wall outlet and charging cord is completely plugged into port on back of unit
Unit will not charge	Charger plug/cord not connected	Make sure charger plug is completely plugged into wall outlet and charging cord is completely plugged into port on back of unit
	Not the correct charger	Use only the charger that comes with the machine
Unit is leaking	Formula tank is not properly seated	Ensure formula tank is fully seated, see page 6
	Dirty tank plug is not sealed properly	Ensure dirty tank plug is sealed properly, see page 10
	Dirty tank is full	Empty dirty tank. Unit should not be left on its side with water in the dirty tank, see page 10
	Unit is not level	Ensure unit is upright, see page 9

Please do not return this product to the store.

Other maintenance or service not included in the manual should be performed by an authorized service representative.

Notes

Consumer Guarantee

This Guarantee only applies outside of the USA and Canada. It is provided by BISSELL International Trading Company BV ("BISSELL").

This Guarantee is provided by BISSELL. It gives you specific rights. It is offered as an additional benefit to your rights under law. You also have other rights under law which may vary from country to country. You can find out about your legal rights and remedies by contacting your local consumer advice service. Nothing in this Guarantee will replace or lessen any of your legal rights or remedies. If you need additional instruction regarding this Guarantee or have questions regarding what it may cover, please contact BISSELL Consumer Care or contact your local distributor.

This Guarantee is given to the original purchaser of the product from new and is not transferable. You must be able to evidence the date of purchase in order to claim under this Guarantee.

Limited 2 Year Guarantee from the date of purchase by original purchaser

Subject to the *EXCEPTIONS AND EXCLUSIONS identified below, BISSELL will repair or replace (with new or remanufactured components or products), at BISSELL's option, free of charge, any defective or malfunctioning part or product.

BISSELL recommends that the original packaging and evidence of the date of purchase be kept for the duration of the Guarantee period in case the need arises within the period to claim on the Guarantee. Keeping the original packaging will assist with any necessary re-packaging and transportation but is not a condition of the Guarantee.

If for your product is replaced by BISSELL under this Guarantee, the new item will benefit from the remainder of the term of this Guarantee (calculated from the date of the original purchase). The period of this Guarantee shall not be extended whether or not your product is repaired or replaced.

*EXCEPTIONS AND EXCLUSIONS FROM THE TERMS OF THE GUARANTEE

This Guarantee applies to products used for personal domestic use and not commercial or hire purposes. Consumable components such as filters, belts and mop pads, which must be replaced or serviced by the user from time to time, are not covered by this Guarantee.

This Guarantee does not apply to any defect arising from fair wear and tear. Damage or malfunction caused by the user or any third party whether as a result of accident, negligence, abuse, neglect, or any other use not in accordance with the User Guide is not covered by this Guarantee.

An unauthorised repair (or attempted repair) may void this Guarantee whether or not damage has been caused by that repair/attempt.

Removing or tampering with the Product Rating Label on the product or rendering it illegible will void this Guarantee.

SAVE AS SET OUT BELOW BISSELL AND ITS DISTRIBUTORS ARE NOT LIABLE FOR ANY LOSS OR DAMAGE THAT IS NOT FORESEEABLE OR FOR INCIDENTAL OR CONSEQUENTIAL DAMAGES OF ANY NATURE ASSOCIATED WITH THE USE OF THIS PRODUCT INCLUDING WITHOUT LIMITATION LOSS OF PROFIT, LOSS OF BUSINESS, BUSINESS INTERRUPTION, LOSS OF OPPORTUNITY, DISTRESS, INCONVENIENCE OR DISAPPOINTMENT. SAVE AS SET OUT BELOW BISSELL'S LIABILITY WILL NOT EXCEED THE PURCHASE PRICE OF THE PRODUCT.

BISSELL DOES NOT EXCLUDE OR LIMIT IN ANY WAY ITS LIABILITY FOR (A) DEATH OR PERSONAL INJURY CAUSED BY OUR NEGLIGENCE OR THE NEGLIGENCE OF OUR EMPLOYEES, AGENTS OR SUBCONTRACTORS; (B) FRAUD OR FRAUDULENT MISREPRESENTATION; (C) OR FOR ANY OTHER MATTER WHICH CANNOT BE EXCLUDED OR LIMITED UNDER LAW.

Consumer Care

If your BISSELL product should require service or to claim under our limited guarantee, please contact us as follows:

Website:

www.BISSELL.com

Email:

UKSupport@bissell.com

Telephone:

0344-888-6644

Write:

BISSELL Homecare (Overseas) Inc.
Ground Floor
226 Berwick Avenue
Slough, Berkshire, SL1 4QT
United Kingdom

Spares are available for purchase.

To purchase visit www.4bissell.co.uk

Visit the BISSELL website: www.BISSELL.com

When contacting BISSELL, have model number of cleaner available.

Please record your Model Number: _____ Please record your Purchase Date: _____

NOTE: Please keep your original sales receipt. It provides proof of the date of purchase in the event of a Guarantee claim. See Guarantee for details.



©2017 BISSELL Homecare, Inc.
Grand Rapids, Michigan
All rights reserved. Printed in China
Part Number 161-3019 06/17
Visit our website at: www.BISSELL.com